

# **A6 EnergySaver**

## OPERATIONS GUIDE



# OPEN

Stop. Look. Work Safely.

## STEP 1

Remove screens and wash pump filter and inspect for debris. 2.



Clean as required and replace to the proper position when finished.



## STEP 2

Inspect spray arms within the dishmachine cabinet to ensure spray arms rotate freely. Ensure that the jets are free of debris and the end caps are closed.



## STEP 3

Lower the door until there is about an inch gap at the bottom.

## STEP 4

Turn the machine on.

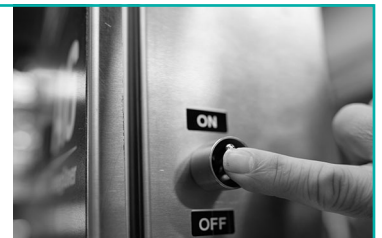

## STEP 5

Allow water to heat for 20 minutes.

# OPEN

Stop. Look. Work Safely.

## STEP 6

Close the door. At this point, the machine should start the wash cycle. If it does not start, Press the Start button.



## STEP 7

The detergent peripump should start to turn.

- a. For high temp machines: When the wash pump stops, the Rinse aid per pump should turn.
- b. For low temp machines: When the wash pump stops, the chlorine and rinse aid per pumps should turn.

## STEP 8

Check product supply containers and verify levels are adequate. Replace empty containers as necessary.



## STEP 1

Fully insert rack into dishmachine.



## STEP 2

Close the door. The dishwasher should start now. If it doesn't, push the start button.



## STEP 3

Once the rinse portion is complete, open the door and remove the rack.



Drain and refill the wash tank every 2 hours.



Regularly verify chemical containers to ensure that they have chemicals in them.



For low temp machines, verify sanitation levels are between 50 and 200 ppm with a test strip. Use a dish or glass that just came out of the machine and place the strip on a wet part. Contact your service representative if you still have trouble verifying sanitation levels.

# CLOSE

Stop. Look. Work Safely.

## STEP 1

Turn the machine off.



## STEP 2

Pull the wash pump filter to allow the wash cavity to empty.



## STEP 3

Remove screens and inspect for debris. Clean screens and filter as required.



## STEP 4

Inspect the wash cavity for debris.  
Spray debris down the drain.

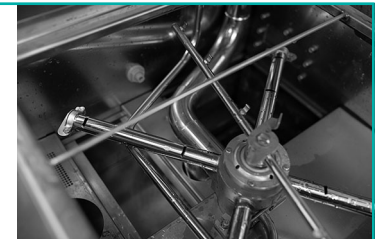

## STEP 5

Replace screens to the proper position when finished.

## STEP 6

Inspect spray arms within the dishmachine cabinet to ensure spray arms rotate freely. Ensure that the jets are free of debris.

- a. If debris is in the wash arm, remove the arm and open the end cap. Flush with water.

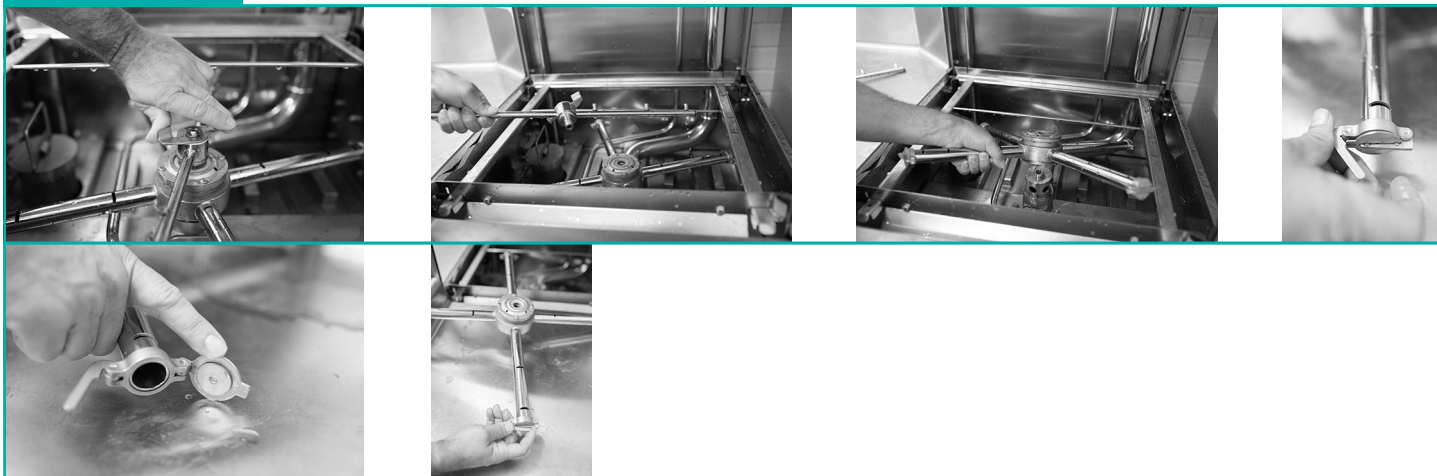

## STEP 7

Replace spray arms.

